



Meadowside

Launceston

PL15 7DJ

Asking Price £315,000

- Detached Bungalow
- Three Double Bedrooms
- Sought After Location
- Delightful & Private Rear Garden
- Recently Re-fitted Kitchen
 - Conservatory
 - Garage & Drive
- Scan QR Code For Material Information



 Millerson
millerson.com

Tenure - Freehold

Council Tax Band - D

Floor Area - 926.00 sq ft



Summary

A spacious and well-presented three-bedroom home offering comfortable, low-maintenance living in a peaceful edge-of-Launceston setting.

The generous 26' living/dining room with woodburner provides a welcoming central space, flowing into a bright conservatory that enjoys pleasant views over the private, mature gardens. A recently refitted kitchen/breakfast room adds modern convenience, while three double bedrooms and a well-appointed bathroom offer excellent flexibility for visiting family or hobbies.

Outside, the enclosed garden provides a quiet retreat, complemented by driveway parking and an attached garage. A superb opportunity for those seeking space, comfort and ease of living in a calm and convenient location.

Summary:

The property has been carefully maintained by the current owner and offers generous, well-balanced accommodation throughout. A welcoming L-shaped entrance hallway sets the tone, leading into an impressive 26' living/dining room complete with a woodburner—perfect for cosy evenings and entertaining alike. This space flows seamlessly into a bright, well-proportioned conservatory, creating a wonderful connection between indoors and out.

From the conservatory, doors open onto a delightful decked terrace, an ideal spot for relaxing or dining while overlooking the private, fully enclosed, and mature rear gardens—a real haven of peace and privacy.

The home also boasts an attractively recently re-fitted kitchen/breakfast room, offering a stylish and practical space for everyday living. There are three genuine double bedrooms, providing excellent flexibility for families, guests, or home working, along with a well-appointed family bathroom featuring a separate walk-in shower.

Externally, the property continues to impress with a private driveway providing off-road parking, as well as an attached 21' garage with an electric door—offering superb convenience, storage, and secure parking.

uPVC double glazed sliding door into

Entrance Porch:

Tiled floor. Front door into

Hallway:

L-shape. Useful storage cupboard with shelving, separate coat and shoe cupboard with hanging rail. Linen cupboard housing a radiator and slatted shelving. Telephone point, radiator, and doors off

Lounge/Dining Room:

26'0" x 11'10" in chimney breast recesses (7.92m x 3.61m in chimney breast recesses) A bright and inviting room with windows to the front and side. The focal point is a charming fireplace with a woodburner set on a slate hearth and framed by a wooden surround. TV point, two radiators, and French doors opening into the conservatory.

Conservatory:

10'5" x 10'0" (3.2m x 3.05m)

A lovely space with double glazed windows and French doors opening onto a decked terrace and the beautiful, private rear garden. The gentle sound of a nearby stream adds to the tranquil setting. Finished with tiled flooring, the room also features a radiator, TV point, multiple sockets, and a ceiling fan with light.

Kitchen/Breakfast Room:

11'5" x 10'9" (3.48m x 3.3m)

A recently re-fitted kitchen offering a stylish and practical layout, complete with soft-closing units and a larder cupboard for excellent storage. A window overlooks the rear garden, and a door opens directly onto the decked terrace, perfect for outdoor dining.

The kitchen is fitted with a range of base units and matching eye-level and display cabinets, complemented by worktop surfaces and part-tiled walls. It includes an inset stainless steel 1½ bowl sink with mixer tap, an integrated dishwasher, space and plumbing for a washing machine, space for a tall fridge/freezer, and an electric range cooker with a canopy extractor fan above.

Also housing the wall-mounted gas combination boiler, the kitchen benefits from a TV point, radiator, and a bright, functional finish throughout.

Principal Bedroom:

11'5" x 10'9" (3.48m x 3.3m)

A window to the rear offers a pleasant outlook over the private garden. The room also features a TV point and radiator.

Bedroom Two:

11'5" x 10'9" (3.48m x 3.28m)

Window to front. Radiator.

Bedroom Three:

11'6" x 7'8" (3.53m x 2.34m)

Window to front. Radiator.

Family Bathroom:

6'9" x excluding shower cubicle 6'2" (2.06m x excluding shower cubicle 1.88m)

A stylish bathroom featuring fully tiled walls and flooring, with an obscure glazed window to the rear for added privacy. The suite includes a panelled bath with Victorian-style mixer tap and shower attachment, a wall-mounted wash hand basin, and a low-level WC. There's also a walk-in shower cubicle with an electric shower and extractor fan, offering functionality.

Outside:

The front garden has been designed with low maintenance in mind, featuring a small lawn and gravelled areas for a neat, tidy appearance. A pedestrian gate and steps lead up to the front entrance, while a private driveway provides access to the attached:

Garage:

21'5" x 9'8" (6.55m x 2.97m)

A good-sized garage with a remote-controlled up-and-over metal door, double glazed side window, and a personal door leading to the rear garden. Benefitting from power, lighting, and high-level storage, it offers excellent practicality for parking or additional storage.



Rear Garden:

Adjacent to the garage, a pedestrian gate opens onto a pathway leading to the fully enclosed, private rear garden. This path extends to a delightful decked terrace, the perfect spot to unwind while enjoying peaceful views of the garden, the gentle sounds of birdsong, and a nearby babbling stream.

The remainder of the garden is laid to lawn and bordered by an attractive mix of mature trees, shrubs, and flowering plants, creating a tranquil and natural retreat. Additional features include a timber shed, greenhouse, and a pergola—ideal for outdoor entertaining or quiet relaxation. Practical touches such as an outside light and water tap add convenience to this lovely outdoor space.

Material Information:

Verified Material Information

Council Tax band: D

Tenure: Freehold

Property type: Bungalow

Property construction: Standard undefined construction

Energy Performance rating: C

Electricity supply: Mains electricity

Solar Panels: No

Other electricity sources: No

Water supply: Mains water supply

Sewerage: Mains

Heating: Mains gas-powered central heating is installed.

Heating features: None

Broadband: FTTP (Fibre to the Premises)

Mobile coverage: O2 - Good, Vodafone - Good, Three - Great, EE - Good

Parking: Garage and Driveway

Building safety issues: No

Restrictions - Listed Building: No

Restrictions - Conservation Area: No



Restrictions - Tree Preservation Orders: None

Public right of way: No

Long-term area flood risk: No

Historical flooding: No

Flood defences: No

Coastal erosion risk: No

Planning permission issues: No

Accessibility and adaptations: None

Coal mining area: No

Non-coal mining area: No

All information is provided without warranty. Contains HM Land Registry data © Crown copyright and database right 2021. This data is licensed under the Open Government Licence v3.0.

The information contained is intended to help you decide whether the property is suitable for you. You should verify any answers which are important to you with your property lawyer or surveyor or ask for quotes from the appropriate trade experts: builder, plumber, electrician, damp, and timber expert.

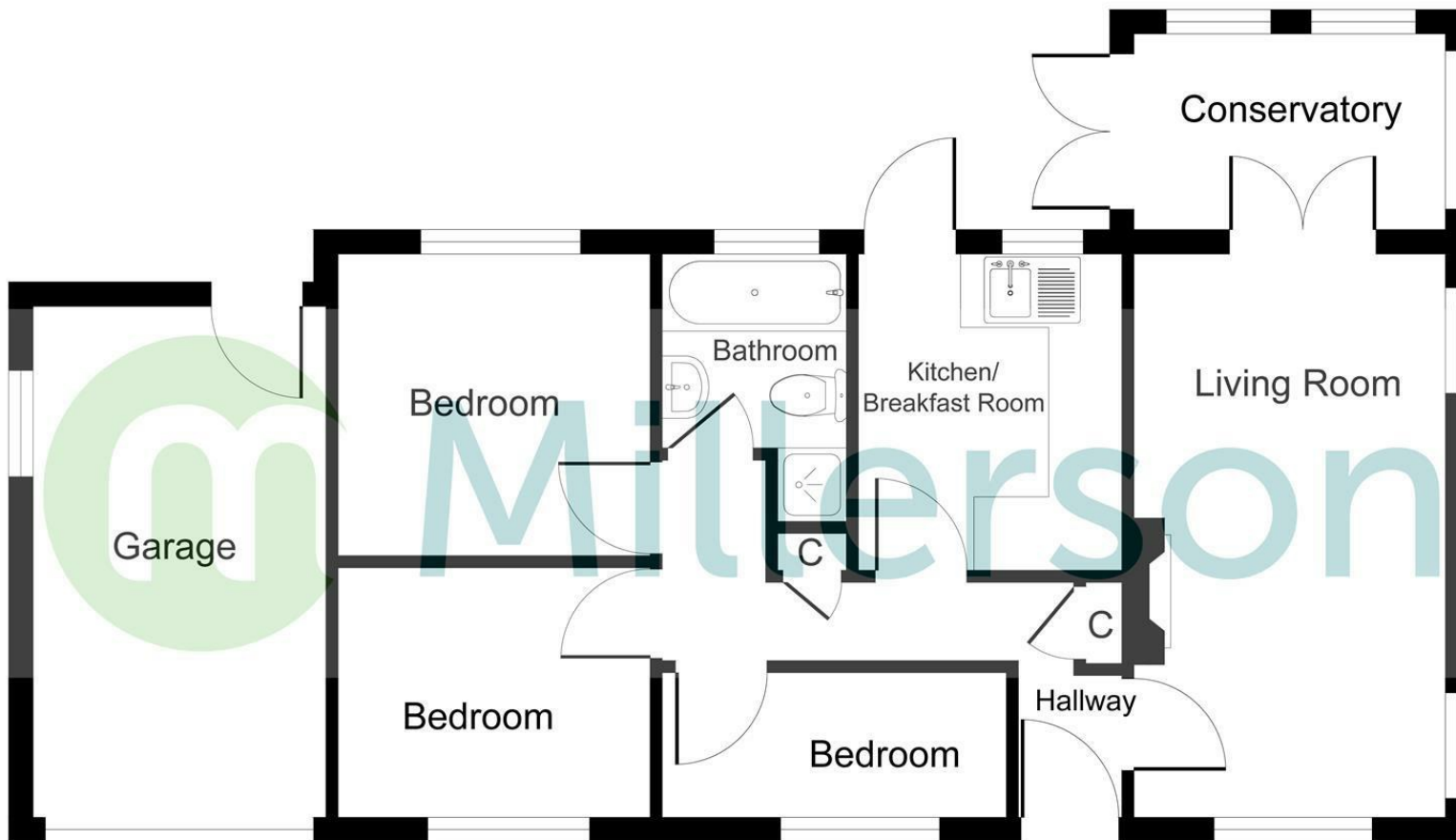

PLEASE NOTE, THIS FLOOR PLAN IS INTENDED FOR ILLUSTRATIVE PURPOSES ONLY. NO MEASUREMENT HAVE BEEN TAKEN AND IT IS NOT TO SCALE.

Copyright V360 Ltd 2025 | www.houseviz.com

Energy Efficiency Rating		Current	Potential
Very energy efficient - lower running costs			
(92 plus) A			
(81-91) B			
(69-80) C		70	77
(55-68) D			
(39-54) E			
(21-38) F			
(1-20) G			
Not energy efficient - higher running costs			
England & Wales		EU Directive 2002/91/EC	

Needing To Sell?

Are you interested in this property but aren't currently in a proceedable position?

Don't Panic!

Contact Us On The Details Below To Arrange A Valuation

Here To Help

Millerson Estate Agents
6a High Street
Launceston
Cornwall

PL15 8ER

E: launceston@smartmillerson.co.uk

T: 01566 776055

www.millerson.com

Scan QR Code For Material Information



Scan me!

 **Millerson**
millerson.com